

- Loading procedure:
 1 - Unscrew bolt
 2 - Pull out shot
 3 - Push back piston
 4 - Cock firing pins
 with loading tool
 5 - Press in, turn 45°
 6 - Load blank (with empty
 chamber of 1st trigger.)

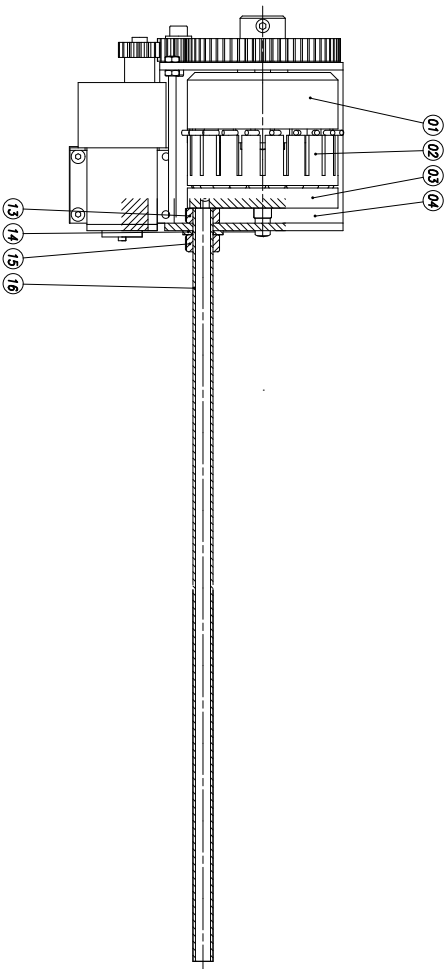
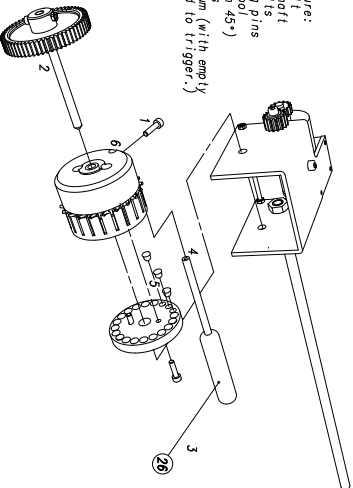

26	1	loading tool		RC-T-02-10
25	1	Trigger	SIST_304	RC-T-02-10
24	1	Hexagon Nut M4	ISO 4032 (DIN 934)	
23	1	H.S.H. Cap screw M4x8	SIST_304	ISO 4782 (DIN 912)
22	1	Gear M1-60T	MS58	Comrad-23 74 50-51
21	1	Bushing D=6/7=5/L=9-5	MS58	
20	1	Washer M3 3x0	SIST_304	ISO 7093 (DIN 9021)
19	1	H.S.H. Cap screw M4x16	SIST_304	ISO 4782 (DIN 912)
18	1	Gear M1-15T	Acetal	Comrad-23 73 29-51
17	1	Motor 85rpm		Comrad-22 23 74-51
16	1	Barrel	SIST_304	RC-T-02-10
15	1	Nut M8F	SIST_304	
14	1	Washer M8	SIST_304	ISO 7089 (DIN 1254)
13	1	Nut M8F Flot	SIST_304	
12	1	Th. rod M3/L=72	SIST_304	
11	4	H.S.H. Cap screw M4x16	SIST_304	ISO 4782 (DIN 912)
10	1	Shot	SIST_304	RC-T-02-10
09	5	Hexagon Nut M3	SIST_304	ISO 4032 (DIN 934)
08	1	H.S.H. Cap screw M3x20	SIST_304	ISO 4782 (DIN 912)
07	19	Blank blank	MS/SIST	
06	19	Firing pin	Spr.-St.	RC-T-02-06
05	19	Coil spring	AL 505T	RC-T-02-04
04	1	Housing	SIST_304	
03	1	Drum magazine	AL 51ST	RC-T-02-03
02	1	Firing pin drum	AL 51ST	
01	1	Spring drum	AL 51ST	RC-T-02-01
00	1	Part name	MATERIAL	PART NUMBER/REMARKS

RC-Tanks	
Brady	
Form Rev01vergm	
Main ass'y	
Scale: 1:1	0 50 100 150 200 250 300 350 400 450 500 550 600 650 700 750 800 850 900 950 1000
Sheet No. 1	
Iliya Cerjak	
R1-02-00	
R1-02-00	
R1-02-00	
R1-02-00	
R1-02-00	
R1-02-00	
R1-02-00	
R1-02-00	
R1-02-00	
R1-02-00	
R1-02-00	
R1-02-00	
R1-02-00	
R1-02-00	
R1-02-00	
R1-02-00	
R1-02-00	
R1-02-00	
R1-02-00	
R1-02-00	
R1-02-00	
R1-02-00	
R1-02-00	
R1-02-00	
R1-02-00	
R1-02-00	
R1-02-00	
R1-02-00	
R1-02-00	
R1-02-00	
R1-02-00	
R1-02-00	
R1-02-00	
R1-02-00	
R1-02-00	
R1-02-00	
R1-02-00	
R1-02-00	
R1-02-00	
R1-02-00	
R1-02-00	
R1-02-00	
R1-02-00	
R1-02-00	
R1-02-00	
R1-02-00	
R1-02-00	
R1-02-00	
R1-02-00	
R1-02-00	
R1-02-00	
R1-02-00	
R1-02-00	
R1-02-00	
R1-02-00	
R1-02-00	
R1-02-00	
R1-02-00	
R1-02-00	
R1-02-00	
R1-02-00	
R1-02-00	
R1-02-00	
R1-02-00	
R1-02-00	
R1-02-00	
R1-02-00	
R1-02-00	
R1-02-00	
R1-02-00	
R1-02-00	
R1-02-00	
R1-02-00	
R1-02-00	
R1-02-00	
R1-02-00	
R1-02-00	
R1-02-00	
R1-02-00	
R1-02-00	
R1-02-00	
R1-02-00	
R1-02-00	
R1-02-00	
R1-02-00	
R1-02-00	
R1-02-00	
R1-02-00	
R1-02-00	
R1-02-00	
R1-02-00	
R1-02-00	
R1-02-00	
R1-02-00	
R1-02-00	
R1-02-00	
R1-02-00	
R1-02-00	
R1-02-00	
R1-02-00	
R1-02-00	
R1-02-00	
R1-02-00	
R1-02-00	
R1-02-00	
R1-02-00	
R1-02-00	
R1-02-00	
R1-02-00	
R1-02-00	
R1-02-00	
R1-02-00	
R1-02-00	
R1-02-00	
R1-02-00	
R1-02-00	
R1-02-00	
R1-02-00	
R1-02-00	
R1-02-00	
R1-02-00	
R1-02-00	
R1-02-00	
R1-02-00	
R1-02-00	
R1-02-00	
R1-02-00	
R1-02-00	
R1-02-00	
R1-02-00	
R1-02-00	
R1-02-00	
R1-02-00	
R1-02-00	
R1-02-00	
R1-02-00	
R1-02-00	
R1-02-00	
R1-02-00	
R1-02-00	
R1-02-00	
R1-02-00	
R1-02-00	
R1-02-00	
R1-02-00	
R1-02-00	
R1-02-00	
R1-02-00	
R1-02-00	
R1-02-00	
R1-02-00	
R1-02-00	
R1-02-00	
R1-02-00	
R1-02-00	
R1-02-00	
R1-02-00	
R1-02-00	
R1-02-00	
R1-02-00	
R1-02-00	
R1-02-00	
R1-02-00	
R1-02-00	
R1-02-00	
R1-02-00	
R1-02-00	
R1-02-00	
R1-02-00	
R1-02-00	
R1-02-00	
R1-02-00	
R1-02-00	
R1-02-00	
R1-02-00	
R1-02-00	
R1-02-00	
R1-02-00	
R1-02-00	
R1-02-00	
R1-02-00	
R1-02-00	
R1-02-00	
R1-02-00	
R1-02-00	
R1-02-00	
R1-02-00	
R1-02-00	
R1-02-00	
R1-02-00	
R1-02-00	
R1-02-00	
R1-02-00	
R1-02-00	
R1-02-00	
R1-02-00	
R1-02-00	
R1-02-00	
R1-02-00	
R1-02-00	
R1-02-00	
R1-02-00	
R1-02-00	
R1-02-00	
R1-02-00	
R1-02-00	
R1-02-00	
R1-02-00	
R1-02-00	
R1-02-00	
R1-02-00	
R1-02-00	
R1-02-00	
R1-02-00	
R1-02-00	
R1-02-00	
R1-02-00	
R1-02-00	
R1-02-00	
R1-02-00	
R1-02-00	
R1-02-00	
R1-02-00	
R1-02-00	
R1-02-00	
R1-02-00	
R1-02-00	
R1-02-00	
R1-02-00	
R1-02-00	
R1-02-00	
R1-02-00	
R1-02-00	
R1-02-00	
R1-02-00	
R1-02-00	
R1-02-00	
R1-02-00	
R1-02-00	
R1-02-00	
R1-02-00	
R1-02-00	
R1-02-00	
R1-02-00	
R1-02-00	
R1-02-00	
R1-02-00	
R1-02-00	
R1-02-00	
R1-02-00	
R1-02-00	
R1-02-00	
R1-02-00	
R1-02-00	
R1-02-00	
R1-02-00	
R1-02-00	
R1-02-00	
R1-02-00	
R1-02-00	
R1-02-00	
R1-02-00	
R1-02-00	
R1-02-00	
R1-02-00	
R1-02-00	
R1-02-00	
R1-02-00	
R1-02-00	
R1-02-00	
R1-02-00	
R1-02-00	
R1-02-00	
R1-02-00	
R1-02-00	
R1-02-00	
R1-02-00	
R1-02-00	
R1-02-00	
R1-02-00	
R1-02-00	
R1-02-00	
R1-02-00	
R1-02-00	
R1-02-00	
R1-02-00	
R1-02-00	
R1-02-00	
R1-02-00	
R1-02-00	
R1-02-00	
R1-02-00	
R1-02-00	
R1-02-00	
R1-02-00	
R1-02-00	
R1-02-00	
R1-02-00	
R1-02-00	
R1-02-00	
R1-02-00	
R1-02-00	
R1-02-00	
R1-02-00	
R1-02-00	
R1-02-00	
R1-02-00	
R1-02-00	
R1-02-00	
R1-02-00	
R1-02-00	
R1-02-00	
R1-02-00	
R1-02-00	